

## NEXT STEPS

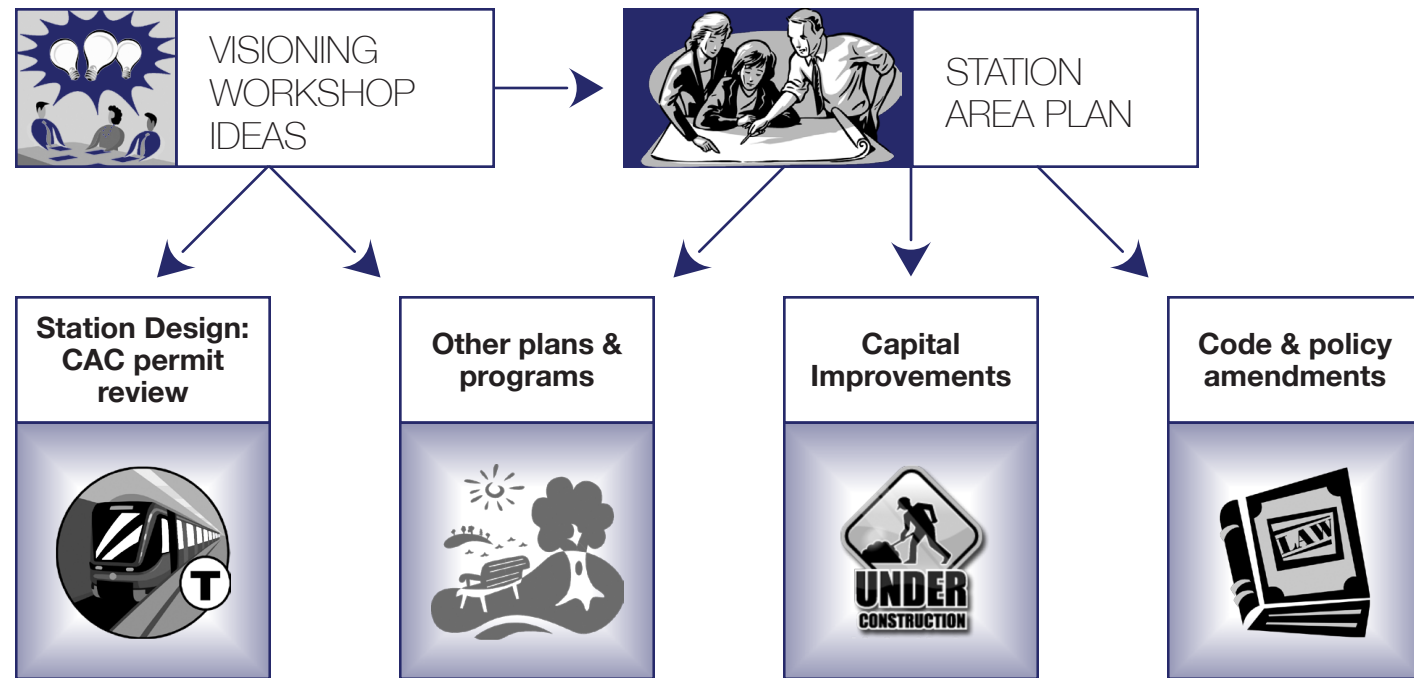

### East Main Station Area Planning CITIZEN ADVISORY COMMITTEE

The East Main Station Area Planning Citizen Advisory Committee (East Main CAC)—a group of 11 residents and business owners from the study area—was appointed by the City Council in August 2014.

The group will work with city staff and the community to identify opportunities and concerns to be studied and addressed in the East Main Station Area Plan. At the end of an approximately year-long process, the East Main CAC will make recommendations to the City Council about which strategies in the plan to pursue. The East Main CAC will not be addressing the East Main station or the Sound Transit light rail system itself.

East Main CAC meetings are public and occur the fourth Tuesday of each month in room 1E-113 of City Hall from 4:00–6:00 p.m. Public comment is available at the start and end of each meeting.

### Follow-up & Contact Information

#### CITY OF BELLEVUE

**Kate March** • (425) 452-2055  
 kmarch@bellevuewa.gov  
 www.bellevuewa.gov/light-rail.htm

*For questions about Bellevue's work on light rail including station area planning, permitting, etc.*

#### SOUND TRANSIT

**Luke Lamon** • (206) 903-7469  
 Luke.Lamon@soundtransit.org  
 www.soundtransit.org/Projects-and-Plans/East-Link-Extension

*For questions about Sound Transit's work on light rail.*



EAST MAIN STATION

The City of Bellevue  
**East Main Station Area Planning  
 Citizen Advisory Committee**  
 wants to hear from you!



The October 28 open house offers you an opportunity to contribute to the vision for the area surrounding the future East Main light rail station. Please share your thoughts and ideas about:

- Current and future neighborhood character
- Neighborhood access, traffic and parking
- Pedestrian, bicycle and transit connections to the station
- A vision for the future development of the east side of 112th Avenue SE

Your input will form the basis for this station area plan—a City of Bellevue program separate from the Sound Transit station design work—to prepare for the addition of a light rail station to the area.

**For more information, visit**  
 www.bellevuewa.gov/east-main-station.htm



# STATION AREA PLANNING

## How is station area planning different from station design?

- » **Station design** concerns the physical layout, appearance and function of the light rail station—Sound Transit’s responsibility.
- » **Station area planning** deals with access, zoning and land use around the station—the City of Bellevue’s responsibility.

## What is the purpose of station area planning?

- » to create a more compatible fit with the neighborhood
- » to take advantage of the station location by making it easier to get to

# REDEVELOPMENT POTENTIAL



What kinds of businesses, activities and features would appeal to you in this area?

# ACCESS CHANGES

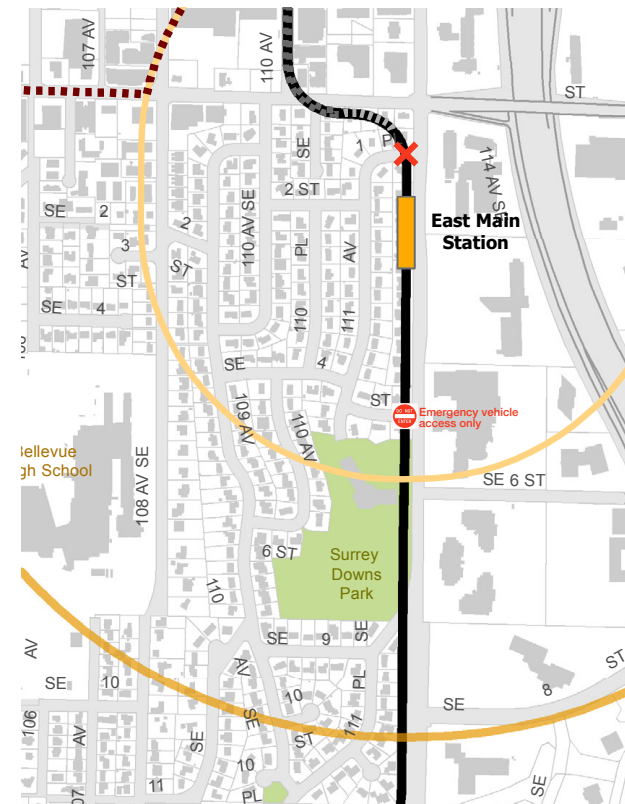

Access to Surrey Downs neighborhood from 112th will be closed at SE 1st Place and 4th Street.

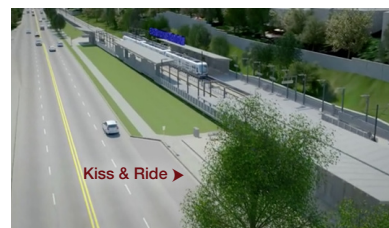

SE 1st PLACE CLOSED at 112th Ave SE



SE 4th STREET CLOSED at 112th Ave SE

