

R=1.5'
FACE OF
CURB (TYP.)

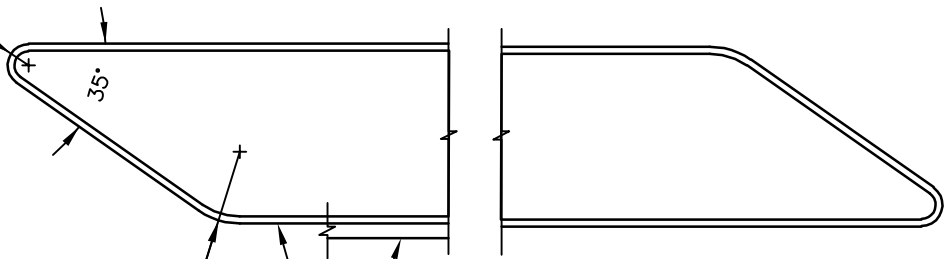

R=5'
FACE OF
CURB (TYP.)

VERTICAL TRAFFIC
CURB OR CURB
AND GUTTER, TYP.

MEDIAN NOSE LAYOUT

NOTES:

1. FOR TYPICAL CHANNELIZATION AT MEDIAN ISLAND, SEE STD. DWG. NO. CH-220-1.
2. IF MEDIAN IS LESS THAN 8' IN WIDTH, ANGLING OF CROSSWALK REFUGE MAY NOT BE REQUIRED, AS DETERMINED BY REVIEW ENGINEER.
3. FOR MEDIAN WITH PATTERNED COLORED CONCRETE SURFACE, COLOR SHALL BE 417 APPLE RED BY SOLOMON, OR APPROVED EQUAL, AND PATTERN SHALL BE CONTINUOUS RUNNING BOND, 8"x4" UNIT.

VERTICAL TRAFFIC
CURB, TYP.

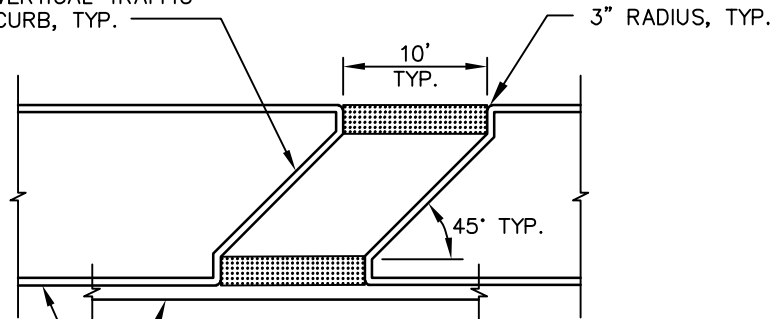

VERTICAL TRAFFIC
CURB OR CURB
AND GUTTER, TYP.

AT-GRADE CROSSWALK REFUGE



MEDIAN ISLAND DETAILS

DRAWING NUMBER	RC-121-1
SCALE	NONE
REVISION DATE	2/25
DEPARTMENT	TRANS