

Neighborhood Enhancement Program

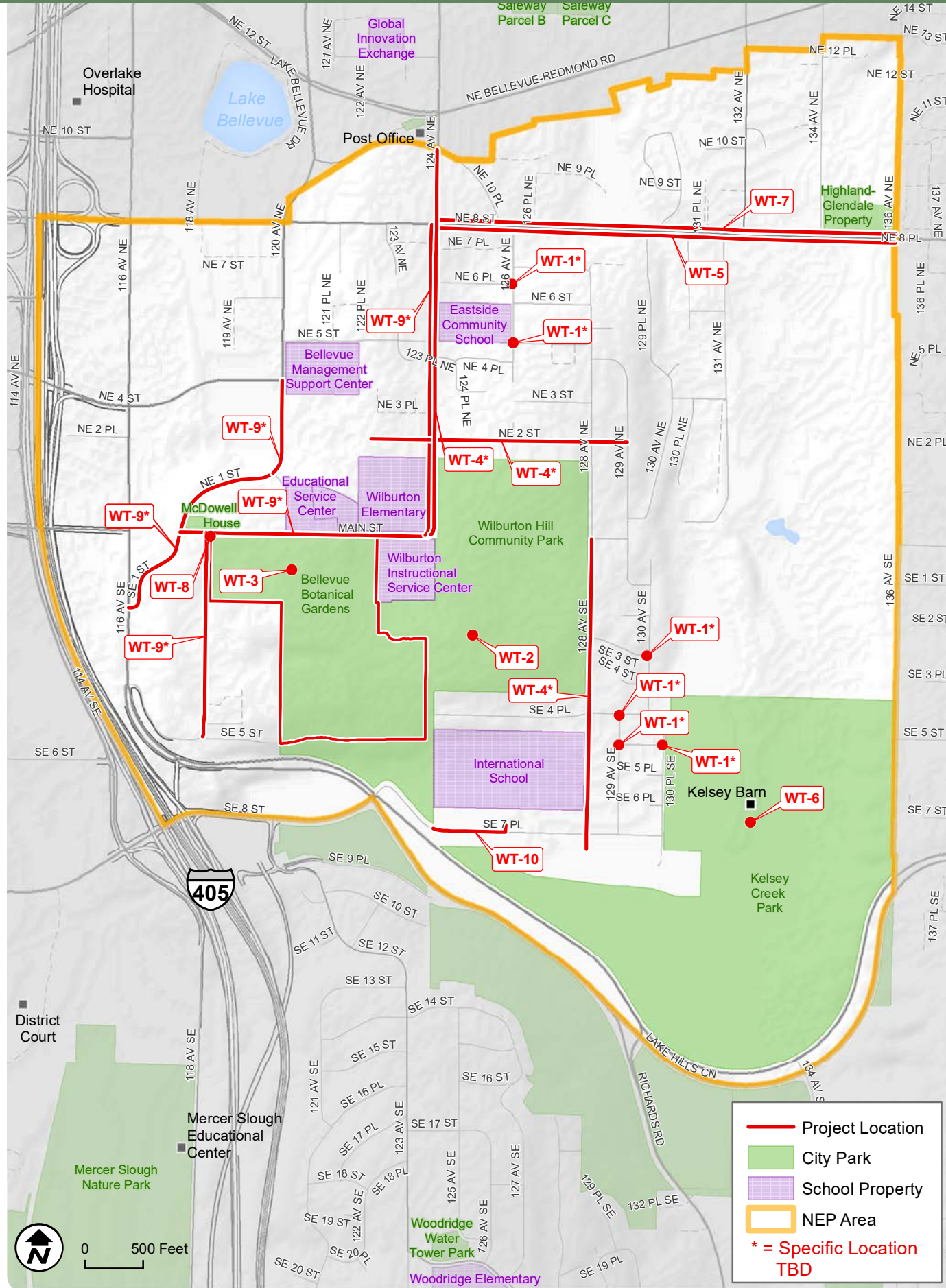

Remove pre-paid ballot and drop in the mail by October 23, 2020. Thank you for your participation! To view a larger version of this map, please visit BellevueWA.gov/nep

Wilburton VOTER'S PAMPHLET & BALLOT



It's what you've been waiting for...time to vote!

The Wilburton area has received \$133,000 to implement residents' desired enhancement projects, and we need your vote!

In the spring of 2020, the city received 64 requests to enhance the livability of Wilburton in various ways. Using these requests, we were able to generate 10 enhancement projects, which are described in this pamphlet. The requests that were not developed into projects either did not meet the NEP criteria, were referred to other city departments, or are being addressed by ongoing city work programs.

Please identify on your ballot, in priority order, which three projects you feel are most deserving of these funds. Three points will be assigned to your first choice, two to your second, and one to your third. We will tabulate your responses and fund the highest-scoring projects with the \$133,000 NEP allocation. You will receive a newsletter in late November 2020 with information on the winning projects and the associated project managers, which will also be posted on the NEP website (BellevueWA.gov/nep)

Please select your top three projects by completing and returning the enclosed postage paid ballot by **Friday, October 23, 2020. Ballots postmarked after this date will not be accepted.** Please contact Theresa Cuthill with any questions at tcuthill@bellevuewa.gov or 425-452-4186.

* Printing, mailing and administrative costs included in the \$133,000 funding allocation.



BALLOT INSIDE
MAKE YOUR VOTE COUNT
MAIL IN NOW!
OCTOBER 23, 2020 DEADLINE

The City of Bellevue
Neighborhood Enhancement Program
Wilburton



PRRST STD
U.S. POSTAGE
PAID
PERMIT #61
BELLEVUE, WA

Community Development
PO Box 90012
Bellevue, WA 98009-9012



Neighborhood Enhancement Program Proposed Projects

WT-1: Wilburton Corner Street Lighting **\$20,000**

Various locations in Wilburton neighborhood

This project would install new LED street lights on existing PSE utility poles at select intersections of neighborhood streets in the Wilburton area. Up to six (6) new street lights would be installed. Ongoing electricity costs would be paid for by the city.

WT-2: Wilburton Hill Park Ivy Out **\$75,000**

Wilburton Hill Park

This project would involve the removal of non-native English ivy (*Hedera helix*) from natural forested areas within Wilburton Hill Park. The scope of work would involve removal of English ivy from the forest floor and removal of ivy growing up existing native trees. Although ivy would be the primary target, other non-native invasive weeds such as hawthorn, Himalayan blackberry and periwinkle would also be removed. All the areas impacted by the removal of invasive weeds would be replanted with native trees and shrubs that are suitable for site conditions. The new plantings would be watered and maintained by city staff until they are established and self-sustainable. This project would result in a more diverse and healthy forest ecosystem at Wilburton Hill Park that would enhance wildlife habitat and improve ecosystem functions.

WT-3: Courtyard Seating Wall **\$75,000**

Bellevue Botanical Garden

This project would convert a prominent planting bed in the Bellevue Botanical Garden's entry courtyard into a raised bed with a low seating wall. This project would provide botanical interest at eye-level for visitors who use wheelchairs as well as seating for visitors waiting for companions to arrive or who are shopping in the Trillium Store. The adjacent walkway would remain intact to ensure that the wall itself is in keeping with the high quality of the existing hardscape. This improvement would allow the City the opportunity to develop a new program that encourages young designers in local college programs to design the space as a class project. Every 3 – 5 years, a winning design to install would be selected. This would keep the bed vibrant and dynamic while providing a high-profile practicum for up-and-coming garden design professionals.

WT-4: Pedestrian Wayfinding Signage **\$30,000**

128th Ave SE, NE 2nd St, 124th Ave NE

This project would install pedestrian wayfinding with directional signage to nearby transit, parks, and destinations in Wilburton. The wayfinding signage would be placed along existing sidewalk paths on 124th Ave NE, NE 2nd St, and 128th Ave SE. Further outreach to residents would be needed to determine signage placement and details.

WT-5: NE 8th St Children's Tiles **\$45,000**

Along NE 8th St between 124th Ave NE and 136th Ave NE

This project would clean and restore original tiles developed by students across the Bellevue School District and then install new tiles designed and developed by Bellevue youth.

WT-6: Kelsey Pollinator Interpretive Display **\$30,000**

Kelsey Creek Park

Bees are excellent pollinators and essential for life on earth. Bees alone are responsible for about one-third of the food we eat. Agriculture is highly dependent on honeybees. Honeybee populations have been in decline for the past decade. This project would create a living, interactive interpretive exhibit at Kelsey Creek Farm. The exhibit would include an observation hive, interpretive signage, and possibly incorporate installation of non-stinging mason bee nests in the park.

WT-7: NE 8th Declining Street Tree and Turf Replacement **\$125,000**

NE 8th St from 124th Ave NE to 136th Ave NE

This project would provide for landscape revitalization and tree planting on NE 8th St between 124th Ave NE and 136th Ave NE. This project would replace declining flowering pear trees with new disease-resistant species. Planter strip improvements would include removing degraded, water-inefficient grass, improving soil conditions, and installation of water-efficient plant combinations selected to further the boulevard's beautification.

WT-8: Neighborhood Gateway **\$75,000**

Lake to Lake Trail at Northwest Corner of Wilburton Hill Park

This project would build off the exceptional qualities of the Wilburton neighborhood and reinforce a strategic and unique confluence of the Lake to Lake Trail, Wilburton Park, and the Bellevue Botanical Garden. The location is the Northwest corner of Main Street and 118th Ave SE. This corner is projected to have pedestrian access and trail improvement completed in 2021, funded by a different city program. This proposed gateway feature would leverage and complement that project by designing and installing an attractive gateway element to welcome and guide all comers to the Wilburton neighborhood.

WT-9: Wilburton Bikeway Enhancements **\$75,000**

Various streets: SE 1st St, Main Street, NE 1st St, 118th Ave SE, 120th Ave NE, 124th Ave NE

This project would install various bikeway enhancements in the Wilburton area to help create safer bicycling conditions on busier neighborhood streets. Depending on location, the improvements would install dedicated bike lanes, shared lane markings, green pavement markings, and bike-related wayfinding signage.

WT-10: SE 7th PI New Walking Path and Associated Improvements **\$118,500**

SE 7th PI between Lake Hills Connector and 128th Ave SE

This project would install a new pedestrian walkway that connects a gap in the sidewalk network between Lake Hills Connector and 128th Ave SE. The pedestrian walkway would be created by shifting existing lanes and would have physical separation from vehicle traffic. This project also includes removal and replacement of an existing speed hump, as well as a new crosswalk to connect to existing sidewalk on the north side of the street. Project cost estimate includes: construction activity, striping, new crosswalk markings, and walking path improvements. Further outreach to residents would be needed to communicate impacts of construction.



For alternate formats, interpreters, or reasonable accommodation requests please phone at least 48 hours in advance 425-452-4186 (voice) or email tcuthill@bellevuewa.gov. For complaints regarding accommodations, contact City of Bellevue ADA/Title VI Administrator at 425-452-6168 (voice). If you are deaf or hard of hearing dial 711. All meetings are wheelchair accessible.



For more information on the proposed ballot projects, including design concepts, please visit the NEP website BellevueWA.gov/nep

September 2020