

# 124th AVE NE ROAD CLOSURE

## STARTING SUMMER 2019

between NE 12th Street and Northup Way (Local Access Only)

Road Improvements	Duration of Road Closure
<b>Build new bridge</b> to accommodate East Link light rail crossing north of 124th Ave NE/NE Spring Boulevard	9 months
<b>Build underground detention vault</b> , south of Ichigo Way	Approximately 1 week
<b>Build new 124th Ave NE/NE Spring Boulevard intersection</b>	8 weekend closures (Friday-Sunday)

### PROJECT INFORMATION

Project update and alert subscription

[BellevueWA.gov/belred-transformation](http://BellevueWA.gov/belred-transformation)

(Select: 124th Ave NE Corridor)

#### Social Media

@BvueTrans (Twitter)

@BellevueWashington (Facebook)

### CITY CONTACT

#### 124th Ave. NE Bridge

Marina Arakelyan, project manager

425-452-4632 | [marakelyan@bellevuewa.gov](mailto:marakelyan@bellevuewa.gov)

#### 124th Ave. NE/NE Spring Boulevard intersection

Steve Costa, project manager:

425-452-2845 | [scosta@bellevuewa.gov](mailto:scosta@bellevuewa.gov)

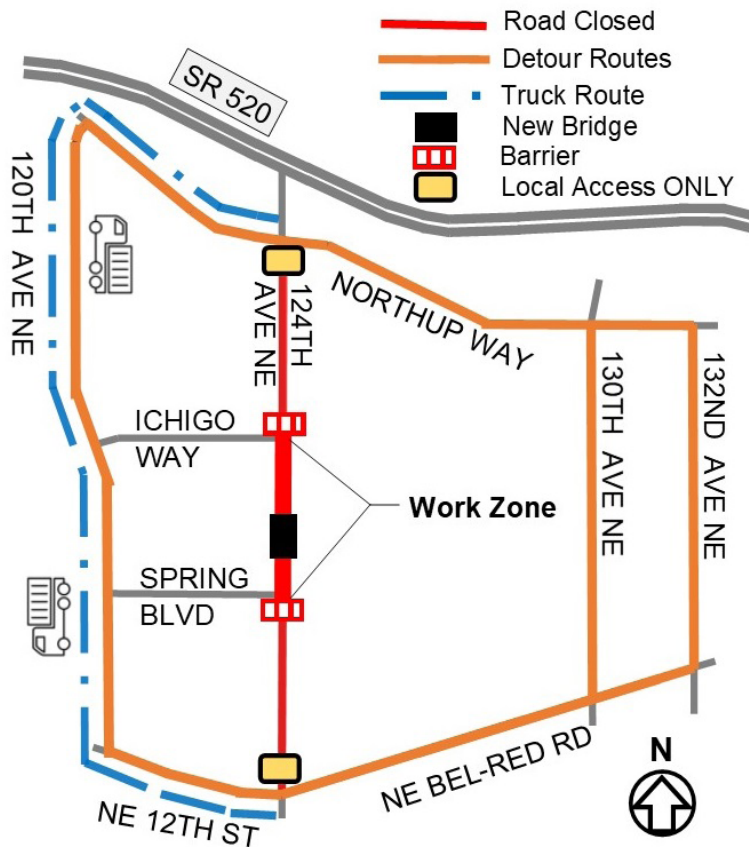

**Information**

정보  情報  
सूचना  資料

**425-452-6800**

సమాచారం Thông Tin  
Información معلومات  
اطلاعات Информация



Transportation