

My Action Plan for 154th Ave SE south of SE 39th St

Are you feeling inspired to take action to address the traffic concerns on 154th Ave SE south of SE 39th St? Here is a checklist to help you get started:

- ☐ Talk to my neighbors and share the City's findings and recommendations
- ☐ List interested neighbors who want to help me with efforts:

- ☐ Decide the educational programs we want to participate in:
 - ☐ Neighborhood Speed Watch
 - ☐ Radar Dolly
 - ☐ Sign and Pledge Program
- ☐ Contact City staff to set-up a training session and get materials

Notes:

More info

Find out more about these recommendations in our **Residential Traffic Guidebook** or by logging on to **Streets are for Everyone (SAFE)**—Neighborhood Traffic Safety Services' blog.

Blog: <http://bellevuentss.wordpress.com>

Guidebook: http://www.bellevuewa.gov/pdf/Transportation/Guidebook_Web.pdf



TRAFFIC ACTION PLAN



BELLEVUE
NEIGHBORHOOD
TRAFFIC
SAFETY
SERVICES

2016-009 154th Ave SE south of SE 39th St



May 23, 2016

Bellevue, WA 98006

Subject: Speeding Concerns on 154th Avenue SE south of SE 39th Street

Dear

Thank you for contacting Neighborhood Traffic Safety Services and letting us know your concerns with vehicle speeds on 154th Ave SE south of SE 39th St. We have completed a field review and data analysis and compiled this information into the enclosed Traffic Action Plan (TAP), as well as our recommendations.

Speed studies were conducted on 154th Ave SE south of SE 39th St at the location you requested as shown on the map on page 2 of this report. The speed studies were conducted April 18-24, 2016 along this 25 mph street. These studies show 85% of motorists are traveling at or below 24 mph in both the northbound and southbound direction. Our speed studies show average speeds along 154th Ave SE of 20 mph in both the northbound and southbound direction. A five-year collision study was also conducted along 154th Ave SE between SE 39th St and SE 41st St, and there were no reported crashes.

You requested the installation of an additional speed hump to slow down speeding motorists. Physical measures such as speed humps are limited to streets where the majority of motorists are exceeding the posted speed limit by 10 mph. These guidelines were established based on the impact these measures have on emergency response. City staff are reviewing the design of the speed humps installed on 154th Ave SE by King County to determine if they meet Bellevue's standards. If the speed humps do not meet the City's standards, they will be removed and reinstalled per our standards.

An option to enhance pedestrian safety for children walking to and from Eastgate Elementary is to paint a pedestrian walkway on one side of 154th Ave SE. This would require restricting parking on that side. If this is something that you and your neighbors would like to pursue, please let us know.

To address those motorists choosing to drive faster than the posted speed limit, we encourage you and your neighbors to participate in one of our education programs as described on page 3 of this report. One of the options that would work well for the situation you've described is to borrow a radar dolly. The radar dolly displays a vehicle's speed on a reader board. The radar dolly has been effective in decreasing vehicle speeds in many areas of Bellevue by encouraging motorists to reduce their speed. I encourage you to fill out the radar dolly request form. Once we receive this form from you, City staff will contact you to make arrangements for both the drop-off and pick-up of the radar dolly at your home.



Again, thank you for sharing your concerns with us. We look forward to working with you and your neighbors on the education programs suggested to address your traffic concerns. Please feel free to contact me at lglas@bellevuewa.gov or 425-452-2841 to participate in any of the education programs described in this Traffic Action Plan.

Sincerely,

Linda Glas, P.E.

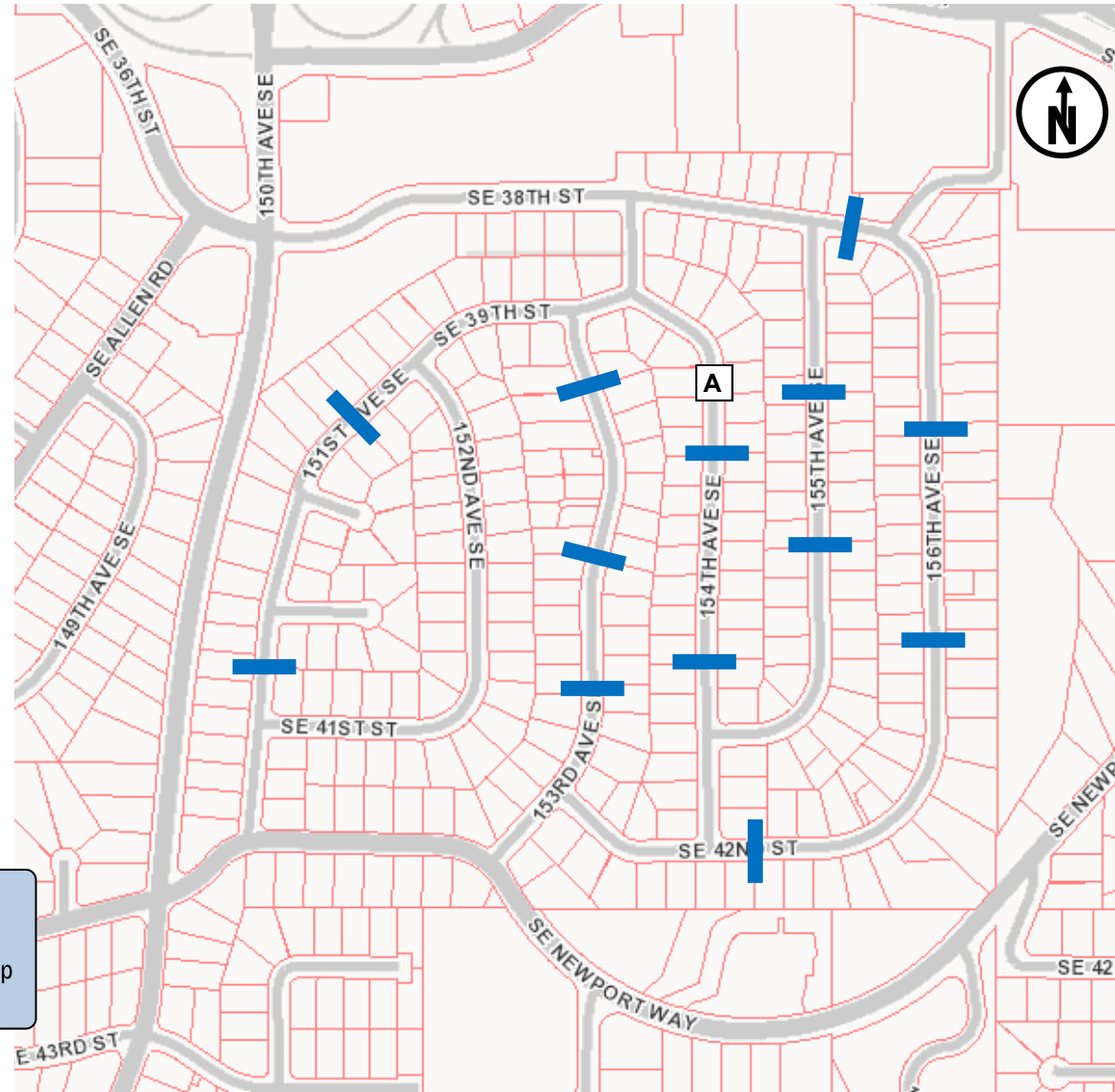

Summary of Findings

Date	Location	Mid-Week Average Daily Traffic^	Average Speeds		85th% Speeds*	
			Northbound	Southbound	Northbound	Southbound
4/18-4/24	A 154th Ave SE	336	20	20	24	24

^Mid-Week Average includes data between Tuesday and Thursday *85% of vehicles traveling at or below this speed

Customized Traffic Action Plan for 154th Ave SE south of SE 39th St

Education, Encouragement, and Enforcement

By educating the community and encouraging safe driving, we can begin to change driver behavior and reduce vehicle speeds.

- Educate the Community
- Enhance Neighborhood Identity
- Reduce Excessive Vehicle Speeds

Neighborhood Speed Watch



Using a borrowed radar unit, you record information about vehicles you observe traveling at or above 30 mph. NTSS staff then locate the registered owners of the vehicles and send a letter to them asking for their cooperation in reducing their speed. A partner to assist you with the data collection is recommended.

Radar Dolly



You can borrow and place a radar dolly on your street for up to two weeks. This unit gives motorists feedback on the speed at which they are driving, encouraging them to obey the speed limit. Should you like to borrow the radar dolly, please request it by calling (425) 452-6457 or sign up on www.bellevuewa.gov/radardolly.htm.

Sign and Pledge Program



This program involves lending communities portable signs that encourage motorists to respect the neighborhood, drive responsibly, and drive 25 mph. The signs are moved by community volunteers from place to place throughout the neighborhood every few days. The second part of the program is a neighborhood pace car program. Residents who pledge to drive responsibly and drive the speed limit on all neighborhood streets receive magnetic bumper stickers or window clings to place on their vehicles. As these motorists drive 25 mph on residential streets, they set the pace for drivers behind them.

