

## My Action Plan for SE 31st St east of 161st Ave SE

Are you feeling inspired to take action to address the traffic concerns on SE 31st St east of 161st Ave SE? Here is a checklist to help you get started:

- ☐ Talk to my neighbors and share the City's findings and recommendations
- ☐ List interested neighbors who want to help me with efforts:

---



---



---

- ☐ Decide the educational programs we want to participate in:
  - ☐ Neighborhood Speed Watch
  - ☐ Radar Dolly
  - ☐ Sign and Pledge Program
- ☐ Contact City staff to set-up a training session and get materials

Notes:

---



---



---



---



---



---



---



---

### More info

Find out more about these recommendations in our **Residential Traffic Guidebook** or by logging on to **Streets are for Everyone (SAFE)**—Neighborhood Traffic Safety Services' blog.

**Blog:** <http://bellevuentss.wordpress.com>

**Guidebook:** [http://www.bellevuewa.gov/pdf/Transportation/Guidebook\\_Web.pdf](http://www.bellevuewa.gov/pdf/Transportation/Guidebook_Web.pdf)



## TRAFFIC ACTION PLAN



BELLEVUE  
NEIGHBORHOOD  
TRAFFIC  
SAFETY  
SERVICES

## 2014-026 SE 31st St east of 161st Ave SE

November 18, 2014



Subject: Speeding and Cut-Through Concerns on SE 31st St east of 161st Ave SE

Dear 

Thank you for contacting Neighborhood Traffic Safety Services and letting us know your concerns with vehicle speeds and cut-through traffic on SE 31st St east of 161st Ave SE. We have completed a field review and data analysis and compiled this information into the enclosed Traffic Action Plan (TAP), as well as our recommendations.

Speed studies were conducted on SE 31st between 162nd Ave SE and 162nd Pl SE. The speed studies were conducted October 9-15, 2014. These studies show 85% of motorists are traveling at or below 26 mph in the eastbound direction and at or below 28 mph in the westbound direction. These speeds are slightly lower than those from a 2006 speed study, where 85% of motorists were traveling at or below 28 mph in the eastbound direction and at or below 30 mph in the westbound direction. There were 3,853 total vehicles (eastbound and westbound) recorded during our weeklong (7 day) study last month, and 5 of these vehicles were recorded travelling over 35 mph at this location (0.1%). A five-year accident study was also conducted along SE 31st St between 161st Ave SE and 165th Ave SE, and there were no reported accidents.

You noted concerns with cut-through traffic on SE 31st St. This street provides residents who live in the neighborhood access to and from their homes. Typically, cut-through traffic pertains to motorists using streets without having an origin or destination within the neighborhood. In looking at the volume studies conducted last month, these volumes are typical based on the number of homes in the vicinity of SE 31st St.

Our records indicate that you have previously requested the installation of speed humps to slow down speeding motorists. Physical measures such as speed humps are limited to streets where the majority of motorists are exceeding the posted speed limit by 10 mph. These guidelines were established based on the impact these measures have on emergency response.

To address those motorists choosing to drive faster than the posted speed limit, we encourage you and your neighbors to participate in one of our education programs as described on page 3 of this report. One of the options that would work well for the situation you've described is to borrow a radar dolly. The radar dolly displays a vehicle's speed on a reader board. The radar dolly has been effective in decreasing vehicle speeds in many areas of Bellevue by encouraging motorists to reduce their speed. I encourage you to fill out the radar dolly request form. Once we receive this form from you, City staff will contact you to make arrangements for both the drop-off and pick-up of the radar dolly at your home.



Again, thank you for sharing your concerns with us. We look forward to working with you and your neighbors on the education programs suggested to address your traffic concerns. Please feel free to contact me at [lglas@bellevuewa.gov](mailto:lglas@bellevuewa.gov) or 425-452-2841 to participate in any of the education programs described in this Traffic Action Plan.

Sincerely,

Linda Glas, P.E.

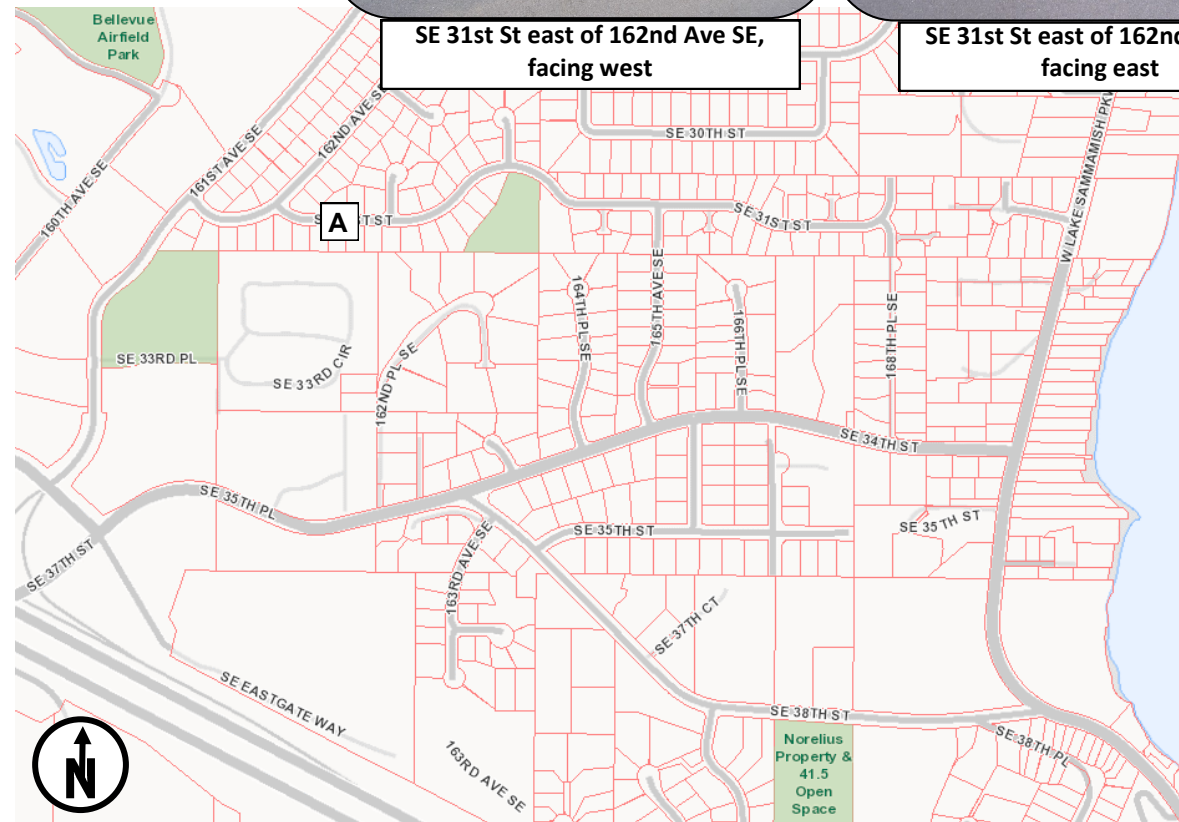

## Summary of Findings

Date	Location	Average Daily Traffic	Average Speeds		85th% Speeds*	
			Eastbound	Westbound	Eastbound	Westbound
Oct 2014	<b>A</b> SE 31st St east of 161st Ave SE	597	22	24	26	28
Aug 2006	<b>A</b> SE 31st St east of 161st Ave SE	454	24	25	28	30
*85% of vehicles traveling at or below this speed						



\*85% of vehicles traveling at or below this speed



## Customized Traffic Action Plan for SE 31st St east of 161st Ave SE

### *Education, Encouragement, and Enforcement*

By educating the community and encouraging safe driving, we can begin to change driver behavior and reduce vehicle speeds.

-  **Educate the Community**
-  **Enhance Neighborhood Identity**
-  **Reduce Excessive Vehicle Speeds**

## Neighborhood Speed Watch



Using a borrowed radar unit, you record information about vehicles you observe traveling at or above 30 mph. NTSS staff then locate the registered owners of the vehicles and send a letter to them asking for their cooperation in reducing their speed. A partner to assist you with the data collection is recommended.

## Radar Dolly



You can borrow and place a radar dolly on your street for up to two weeks. This unit gives motorists feedback on the speed at which they are driving, encouraging them to obey the speed limit. Should you like to borrow the radar dolly, please request it by calling (425) 452-6457 or sign up on [www.bellevuewa.gov/radardolly.htm](http://www.bellevuewa.gov/radardolly.htm).

## Sign and Pledge Program



This program involves lending communities portable signs that encourage motorists to respect the neighborhood, drive responsibly, and drive 25 mph. The signs are moved by community volunteers from place to place throughout the neighborhood every few days. The second part of the program is a neighborhood pace car program. Residents who pledge to drive responsibly and drive the speed limit on all neighborhood streets receive magnetic bumper stickers or window clings to place on their vehicles. As these motorists drive 25 mph on residential streets, they set the pace for drivers behind them.

