

My Action Plan for 160th Ave SE/SE 63rd St

Are you feeling inspired to take action to address the traffic concerns on 160th Ave SE/SE 63rd St? Here is a checklist to help you get started:

- ☐ Talk to my neighbors and share the City's findings and recommendations
- ☐ List interested neighbors who want to help me with efforts:

- ☐ Decide the educational programs we want to participate in:
 - ☐ Neighborhood Speed Watch
 - ☐ Radar Dolly
 - ☐ Sign and Pledge Program
- ☐ Contact City staff to set-up a training session and get materials

Notes:

More info

Find out more about these recommendations in our **Residential Traffic Guidebook** or by logging on to **Streets are for Everyone (SAFE)**—Neighborhood Traffic Safety Services' blog.

Blog: <http://bellevuentss.wordpress.com>

Guidebook: http://www.bellevuewa.gov/pdf/Transportation/Guidebook_Web.pdf



TRAFFIC ACTION PLAN



2014-022 160th Ave SE/SE 63rd St

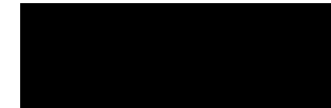

December 5, 2014

Bellevue, WA 98006

Subject: Speeding on 160th Ave SE/SE 63rd St

Dear 

Thank you for contacting Neighborhood Traffic Safety Services and letting us know your concerns with vehicle speeds on 160th Ave SE/SE 63rd St. We have completed a field review and data analysis and compiled this information into the enclosed Traffic Action Plan (TAP), as well as our recommendations.

Speed studies were conducted on 160th Ave SE north of SE 63rd St. The speed studies were conducted September 29-October 5, 2014. These studies show 85% of motorists are traveling at or below 28 mph in the northbound direction and at or below 26 mph in the southbound direction. These speeds are slightly lower than those from a 2004 speed study, where 85% of motorists were traveling at or below 29 mph in the northbound direction and at or below 28 mph in the southbound direction. The average daily traffic along this corridor has remained virtually unchanged — 576 vehicles from the 2004 study and 571 vehicles from the 2014 study. A five-year accident study was also conducted along 160th Ave SE/SE 63rd St, and there were no reported accidents.

To address those motorists choosing to drive faster than the posted speed limit, we encourage you and your neighbors to participate in one of our education programs as described on page 3 of this report. One of the options that would work well for the situation you've described is to borrow a radar dolly. The radar dolly displays a vehicle's speed on a reader board. The radar dolly has been effective in decreasing vehicle speeds in many areas of Bellevue by encouraging motorists to reduce their speed. I encourage you to fill out the radar dolly request form. Once we receive this form from you, City staff will contact you to make arrangements for both the drop-off and pick-up of the radar dolly at your home.

Again, thank you for sharing your concerns with us. We look forward to working with you and your neighbors on the education programs suggested to address your traffic concerns. Please feel free to contact me at lglas@bellevuewa.gov or 425-452-2841 to participate in any of the education programs described in this Traffic Action Plan.

Sincerely,

Linda Glas, P.E.



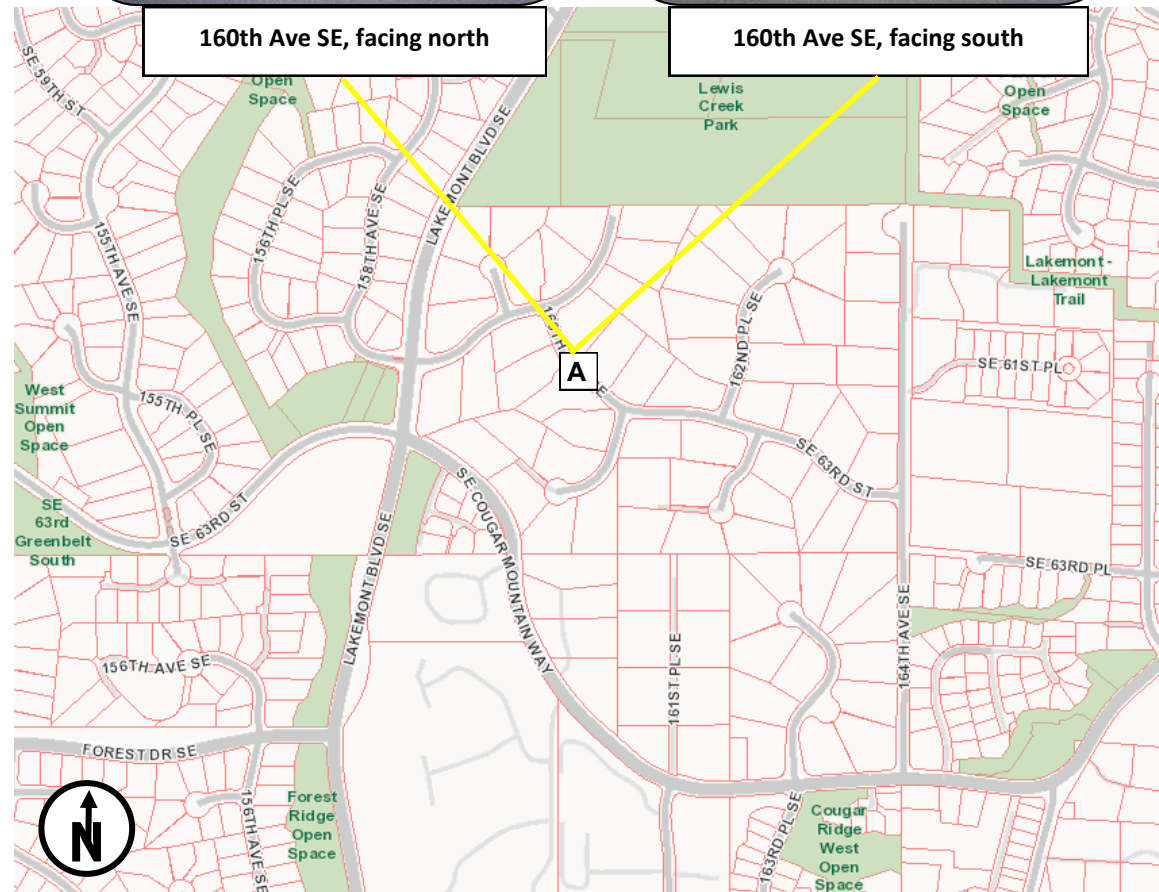

Summary of Findings

| Date | Location | Average Daily Traffic | Average Speeds | | 85th% Speeds* | |
|-----------|---|-----------------------|----------------|------------|---------------|------------|
| | | | Northbound | Southbound | Northbound | Southbound |
| 9/29-10/5 | A 160th Ave SE north of SE 63rd St | 571 | 24 | 22 | 28 | 26 |
| Mar 2004 | A 160th Ave SE north of SE 63rd St | 576 | 25 | 24 | 29 | 28 |

*85% of vehicles traveling at or below this speed



Customized Traffic Action Plan for 160th Ave SE/SE 63rd St

Education, Encouragement, and Enforcement

By educating the community and encouraging safe driving, we can begin to change driver behavior and reduce vehicle speeds.

- Educate the Community
- Enhance Neighborhood Identity
- Reduce Excessive Vehicle Speeds

Neighborhood Speed Watch



Using a borrowed radar unit, you record information about vehicles you observe traveling at or above 30 mph. NTSS staff then locate the registered owners of the vehicles and send a letter to them asking for their cooperation in reducing their speed. A partner to assist you with the data collection is recommended.

Radar Dolly



You can borrow and place a radar dolly on your street for up to two weeks. This unit gives motorists feedback on the speed at which they are driving, encouraging them to obey the speed limit. Should you like to borrow the radar dolly, please request it by calling (425) 452-6457 or sign up on www.bellevuewa.gov/radardolly.htm.

Sign and Pledge Program



This program involves lending communities portable signs that encourage motorists to respect the neighborhood, drive responsibly, and drive 25 mph. The signs are moved by community volunteers from place to place throughout the neighborhood every few days. The second part of the program is a neighborhood pace car program. Residents who pledge to drive responsibly and drive the speed limit on all neighborhood streets receive magnetic bumper stickers or window clings to place on their vehicles. As these motorists drive 25 mph on residential streets, they set the pace for drivers behind them.

