

PIPE AND GATE VALVE SIZE  
TO MATCH CHECK VALVE SIZE

## PLAN

FLOW →

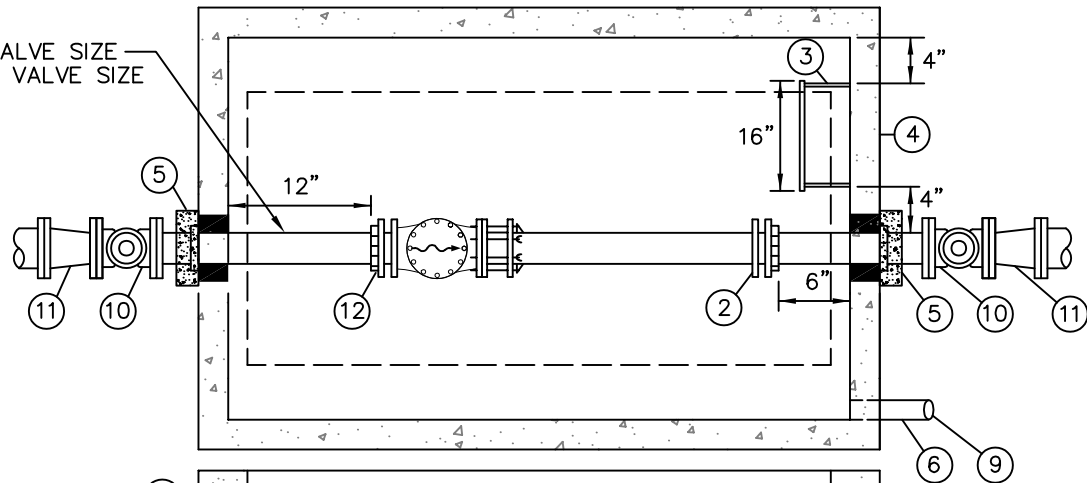

## ELEVATION

FLOW →

SLOPE FLOOR TO DRAIN

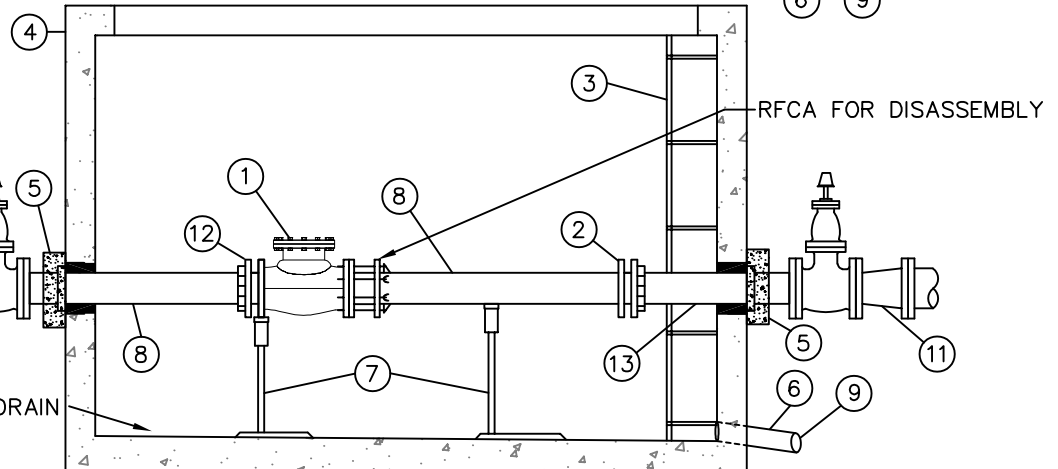

- ① CHECK VALVE WITH TAPPED BODY PORTS (INSTALLED ON VALVE) WITH 3/8" BALL VALVES BOTH UPSTREAM AND DOWNSTREAM. FLOMATIC MODEL 745 AIS COMPLIANT SWING CHECK VALVE OR APPROVED EQUAL.
- ② FLANGE
- ③ ONE GALVANIZED STEEL LADDER TO BE SECURED TO VAULT WITH LADDER-UP (BILCO MODEL LU-2), OR APPROVED EQUAL. LADDER TO BE ATTACHED TO VAULT PER STANDARD DETAIL W-19.
- ④ CONCRETE VAULT WITH 2 LOCKING ALUMINUM LW HATCH DOORS (PART NO. HHD-36"x72"), RATED FOR H-30 LOADING, OR APPROVED EQUAL, WITH SLIP RESISTANT TREATMENT PER SECTION W4-17 OF THE ENGINEERING STANDARDS. COVER TO READ "WATER".
- ⑤ THRUST BLOCK ADJACENT TO VAULT, SEE STANDARD DETAIL W-56. SEAL PIPE PENETRATIONS WITH LINK-SEAL MODULAR SEALS.
- ⑥ DRAIN, SLOPE TO DAYLIGHT OR STORM DRAINAGE SYSTEM, MINIMUM DIAMETER 6".
- ⑦ TWO ADJUSTABLE PIPE STANCHIONS, BOLTED TO FLOOR.
- ⑧ CL. 52 D.I., F.L. x P.E.
- ⑨ INSTALL WIRE MESH RODENT SCREEN OVER DRAIN OUTLET.
- ⑩ 2-GATE VALVE (W/ VALVE BOX & COVER)  
FOR 6": F.L.xF.L.  
FOR 8": F.L.xR.J.
- ⑪ 2-8"x6" REDUCER, F.L.xR.J. (FOR 6" CHECK VALVE ONLY)
- ⑫ RESTRAINED FLANGE ADAPTER, MEGAFLANGE
- ⑬ CL.52 D.I., F.L.xF.L.

MIN. VAULT SIZE (INSIDE)			OLDCASTLE PERCAST MODEL	OLDCASTLE PERCAST TOP *
W	L	H		
4'-0"	6'-6"	4'-5"	577-LA	57TL-20332P

\* COVER MODIFIED PER NOTE ④.

### NOTES:

1. ALL CLEARANCES SHOWN ARE MINIMUM.
2. VAULTS SHALL NOT BE INSTALLED IN AREAS WITH VEHICULAR TRAFFIC.
3. MINIMUM 2' OF LEVEL, UNOBSTRUCTED AREA AROUND HATCHES.
4. VAULT SHALL HAVE COAL TAR COATING OF 5 TO 9 MILS APPLIED TO THE EXTERIOR

JANUARY 2026

NO SCALE



City of  
Bellevue

WATER UTILITY

TITLE

6" AND 8" CHECK VALVE STATION

NO. W-49