

EASTSIDE MEN'S SHELTER AND SUPPORTIVE HOUSING

A partnership between City of Bellevue, King County, King County Public Health, Congregations for the Homeless and Imagine Housing.

Bellevue City Council – August 1, 2016

Presenting:

Camron Parker, Senior Planner

Dan Stroh, Planning Director

Mike McCormick Huentelman, Neighborhood Outreach Manager

Purpose



Should the City enter into a non-binding Letter of Agreement with King County to further evaluate siting a men's shelter and supportive permanent housing facility in Bellevue?

Bellevue Policy Basis

- 2016-17 Council Vision Priorities
 - “Establish an eastside permanent winter homeless shelter to be ready for the winters of 2018-2019”
- 2015 Updated Comprehensive Plan Policies
- 2015 Interest Statement on Homelessness
- 2014 Bellevue Diversity Advantage action plan

Facts and Figures

- 1,200 homeless persons served in Eastside shelters last year
 - 78 men in year-round & 571 men in winter shelter
- 245 people sleeping outside in 2016 Eastside One Night Count of unsheltered individuals
- 252 children enrolled in Bellevue School District's homeless student program
- Bellevue Police and Park Rangers report:
 - Average of 10 unpermitted encampments in open space or rights-of-way
 - 50 vehicles being used for housing in 2016, up from 30 last year

Bellevue Homelessness Response

- **Community Driven**

Congregations for the Homeless, Hopelink, Friends of Youth, Lifewire, Sofia's Way, Imagine Housing

- *All Home King County* coordination

- **Collaboration with Neighboring Cities**

- **Eastside Winter Shelter in Bellevue**

- 2008-11: Crossroads Community Center Crossroads
- 2011-13: St. Peter's United Methodist NE Bellevue
- 2013-15: International Paper (ST) BelRed

Men's Shelter: Program

- Emergency Shelter with approx. 100 beds
- Drop-in Day Center & Cafeteria
- Complementary associated services
 - Medical and health services
 - Case management
 - Employment support
- Service-enriched permanent housing

Men's Shelter: Best Practices

- Nativity House - Tacoma



Eastgate Public Health Center Site

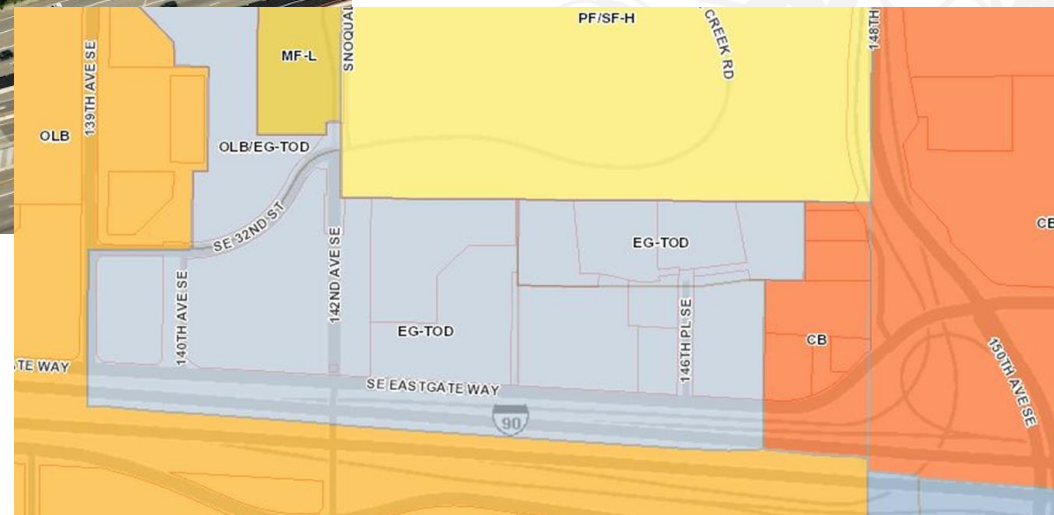

Public Health Site

- Two building pad options on the property
- Both challenging, but feasible

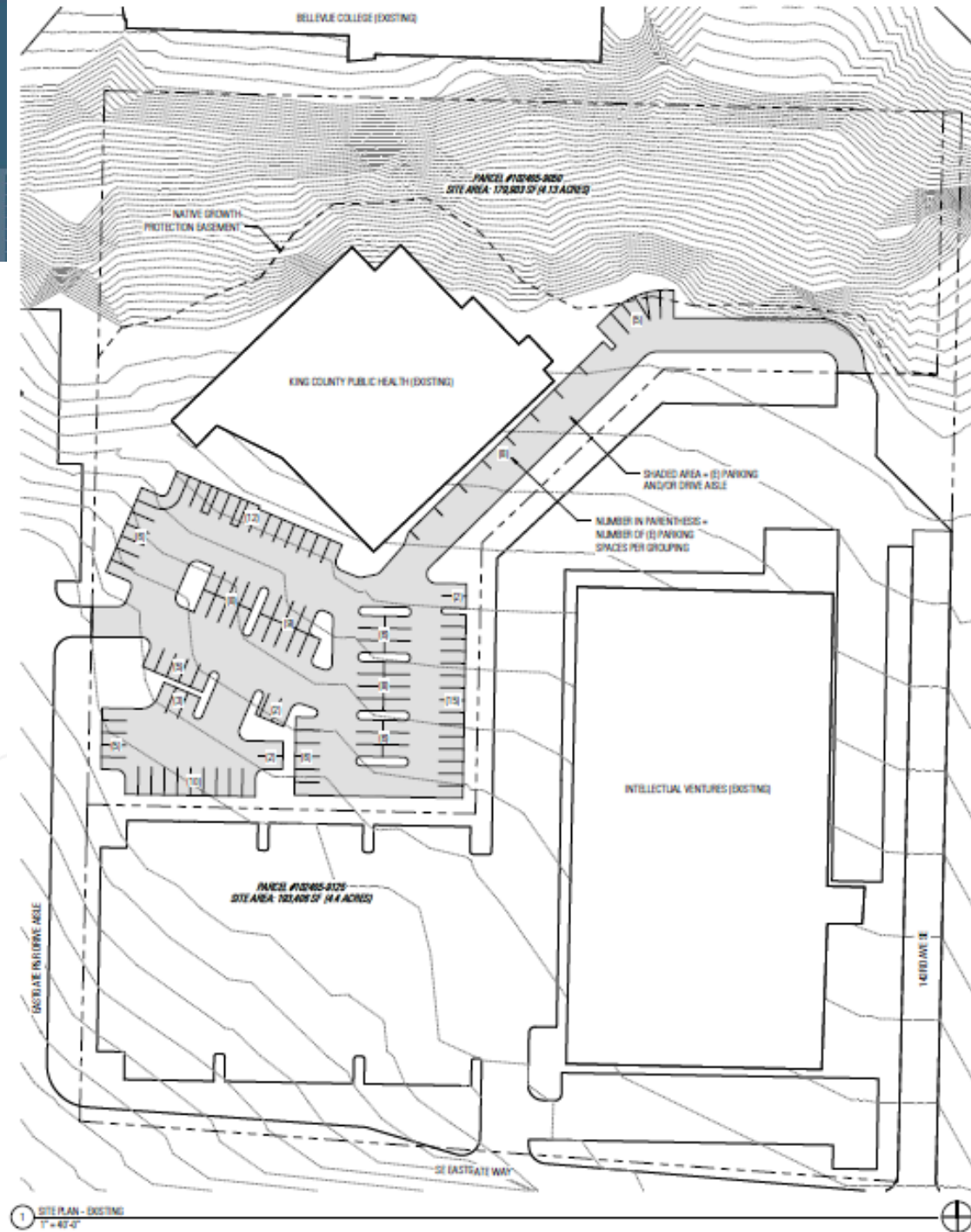

Funding Strategy

- ARCH 2015/2017
- King County Housing Finance 2017
- State Capital Budget 2016
- State Commerce Grant 2016/2018
- State Housing Fund 2017
- Tax Credits 2018
- Private Capital Campaign 2017

Letter of Agreement

- Recognizes mutual interests in developing a partnership to accommodate a shelter, supportive services and permanent housing
- Not a final decision, but intent to work together
- City, County and development team to negotiate agreement for use of property
- City to process code amendments consistent with adopted Eastgate Comprehensive Plan
- City, ARCH, County and development partner to cooperate on funding and program strategy
- City to lead community outreach efforts

Community Outreach Strategy

Surrounding
businesses
and residents

Stakeholder
briefings

September
Community
Meeting

Compilation
Report back
by Q1 2017

- Interested Parties List
- CFH Community Stakeholder Group
- Information and events for surrounding community
- <http://www.bellevuewa.gov/eastside-mens-shelter.htm>

Next Steps

- Move forward with Letter of Agreement
Council direction requested tonight
- Community engagement
- Grant applications by Congregations for the Homeless
- Further site design, study and evaluation

EASTSIDE MEN'S SHELTER AND SUPPORTIVE HOUSING

A partnership between City of Bellevue, King County, King County Public Health, Congregations for the Homeless and Imagine Housing.

Bellevue City Council – August 1, 2016