

NOTES:

1. STAIR TIMBERS TO BE D.F. #2 OR BETTER WITH ROUGH SAWN WALKING SURFACE, PT ACQ/CBA, OR APPROVED EQUAL.
2. ALL CUTS MADE IN THE FIELD SHALL BE TREATED WITH COPPER NAPHTHENATE WOOD PRESERVATIVE, OR APPROVED EQUAL.

- ① 6x8 TIMBER STAIR TREAD
- ② 3' LONG #4 REBAR ANCHOR
- ③ ALUMINUM NON-SLIP TREADS, BROWN IN COLOR, INSTALLED ON ALL TREADS
-USE HANDI-TREADS OR APPROVED EQUAL
-INSTALL PER MANUFACTURER'S SPECIFICATIONS
- ④ EXISTING GRADE OF SLOPE, TYP.

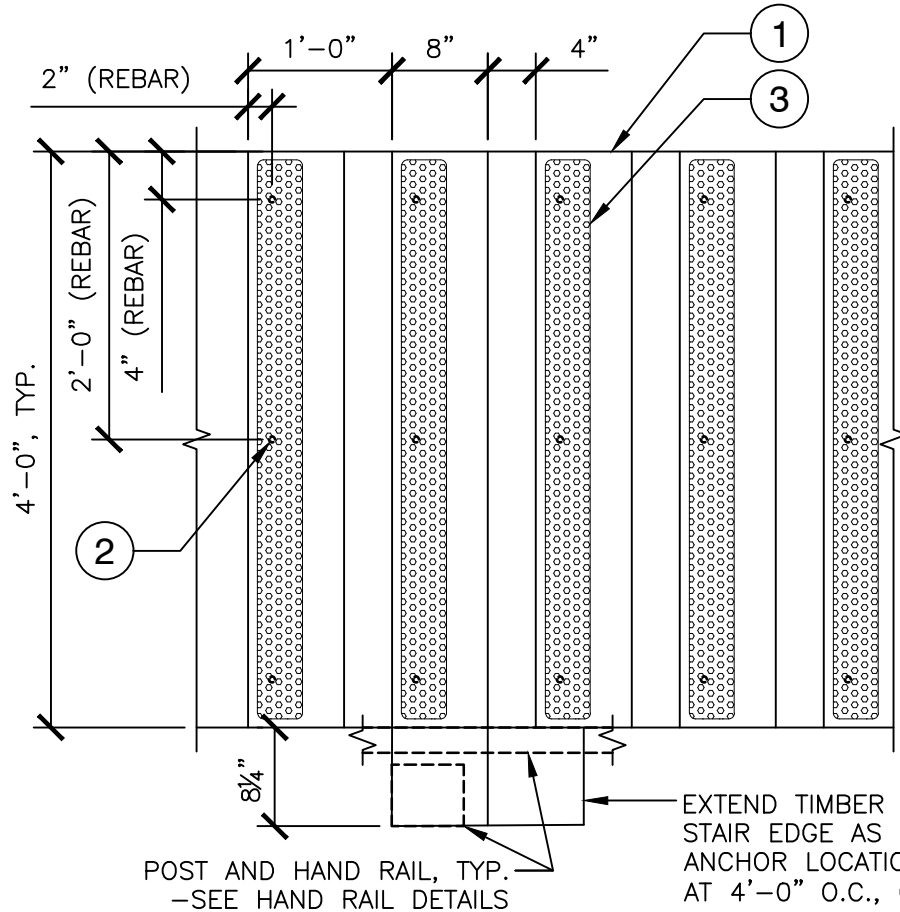

PLAN

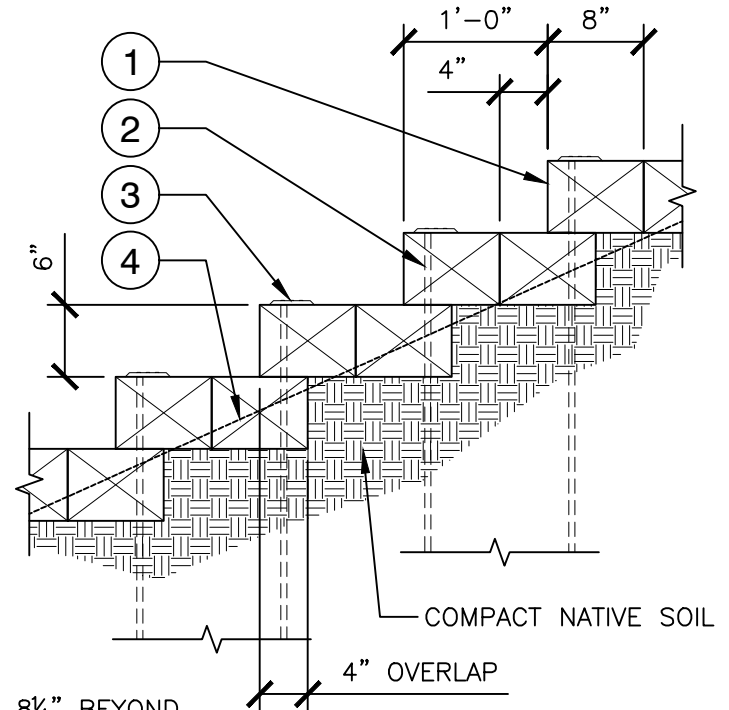

SECTION



City of
Bellevue

TITLE:

COAL CREEK NATURAL AREA - TRAIL - TIMBER STAIRS

DRAWING #:	PK-CC-07A
SCALE:	N.T.S.
REVISION DATE:	03-2021
DEPARTMENT:	PARKS